

USER MANUAL

uPumper mini

V1.0

2024/09/09

SHOWVEN[®]

SHOWVEN Technologies Co., Ltd

Thanks for choosing SHOWVEN uPumper mini, we wish it will bring you lots of exciting moments. Please read the following user's manual and related product installation guide carefully before operating this device.

▲ Safety Instructions

1. Safety icons explanation

Safety instructions warn of hazards when handling equipment and provide information on how to avoid those hazards. They are classified according to the severity of the hazard and are divided into the following groups. Please do follow all safety instructions in this document!

DANGER: Indicates a hazardous situation that, if not avoided, will result in death or serious injury. (This signal word is limited to the most extreme situations)

WARNING: Indicates a hazardous situation that, if not avoided, could result in serious injury

CAUTION: Indicates a hazardous situation that, if not avoided, could result in minor or moderate injury.

NOTICE: Provide additional or supplementary information.

2. General Safety Instructions

- ∨ Unauthorized repair are prohibited, it may cause serious incident.
- ∨ uPumper mini only support specific flame models such as uFlamer II, CIRCLE FLAMER II, uFlamer Max, uFlamer Max Plus etc SHOWVEN new generation liquid flammers with DC12V external power supply interface. Do not use other power supply to running the system.
- ∨ Always have a CO₂ fire extinguisher and an extinguishing blanket in case of needed.
- ∨ If there be any doubt as to the safety operation of the device in any circumstances, the device should be taken out of service immediately. Be sure the device is in good operating condition before use. Any questions please always contact SHOWVEN (info@showven.cn) for help.
- ∨ Be sure to use high quality fuels, otherwise, it is easily leads to failure or danger. Please keep fuels away from heat source, sparks, fire or other possibility of ignition. Do not smoke!
- ∨ The operator responsible for the control of flame system must always have a clear view of the device, so that he/she can stop the show immediately when there is danger. The main AC power switch should near operator. So that operator can turn off the power of all devices in case of abnormal.
- ∨ The device shall not be altered and applied to other use purpose.

3. Disclaimers:

SHOWVEN technologies Co., Ltd excludes liability for unsafe situations, accidents and damages resulting from:

1. Ignoring warnings or regulations as shown on product manual or this manual.
2. Use for other applications or circumstances other than those indicated herein.
3. Changes to the device, including use of non-original spare parts, lack of maintenance etc.
4. Dismantling device without authorization from SHOWVEN.
5. Use this machine by unqualified or untrained personnel.
6. Improper use of machine.

Warning:

A dry powder fire extinguisher, a carbon dioxide fire extinguisher and a fire blanket must be equipped next to the equipment. Someone must be on duty during operation. In case of fire accident, dry powder fire extinguisher can be used when the fire is large, and a carbon dioxide fire extinguisher can be used when the fire is small.

▲ Technical Specifications

- \ **Model:** uPumper mini
- \ **Housing Material:** 304 stainless steel
- \ **Dimension:** 222×114×122mm
- \ **Weight:** 2.9kg
- \ **Input:** DC12V from SHOWVEN FLAMER
- \ **Work Power:** 65W
- \ **Quick Coupler with Flamer Fuel Tank Lid:** Yes
- \ **Indicator Light:** YES
- \ **Power Cable:** DC5.5*2.1mm, 1m
- \ **Fuel In Hose:** Black PU, 3m
- \ **Fuel In Hose Diameter:** outer diameter Φ 10mm, inner diameter Φ 6.5mm
- \ **Fuel Out Hose:** High pressure hose with spring sheath, 1m
- \ **Fuel In Filter:** YES

▲ Structure

uPumper mini mainly consist of 3 parts: fuel tank lid, main part and hoses.

Fuel Tank Lid:

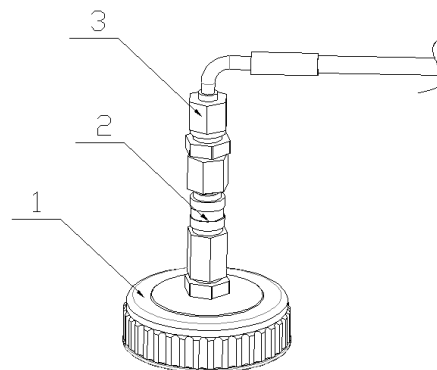

1. Tank lid

2. Quick Coupler

3. Fuel output

Main Part:

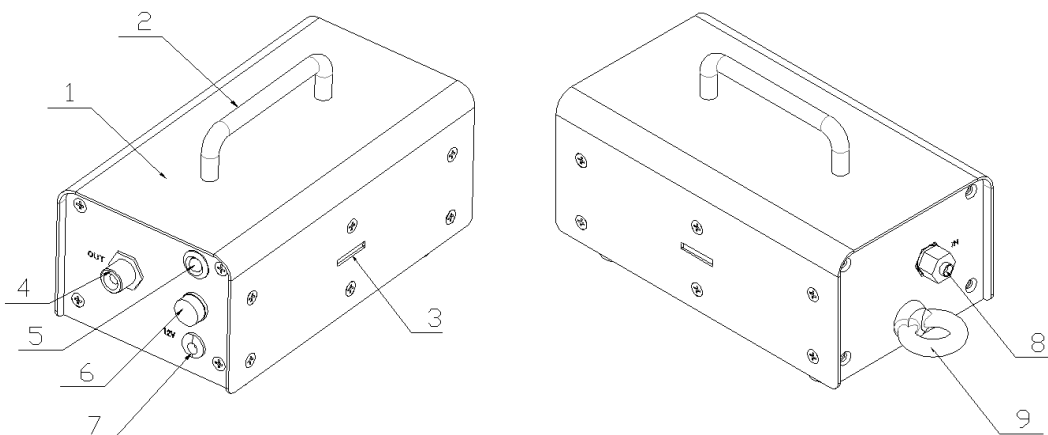

1. Top cover

2. Handle

3. Logo

4. Fuel output connector (connect with tank lid)

5. Indicator light

6. Fuse

7. DC12V power in

8. Fuel input connector

9. Safety loop (optional)

Diagram of bottom panel

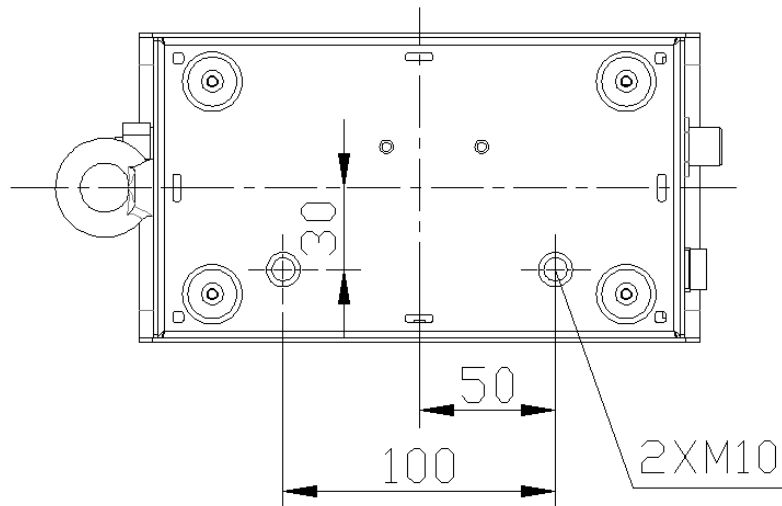

▲ Application Suggestions

Application 1: Installed near flamer

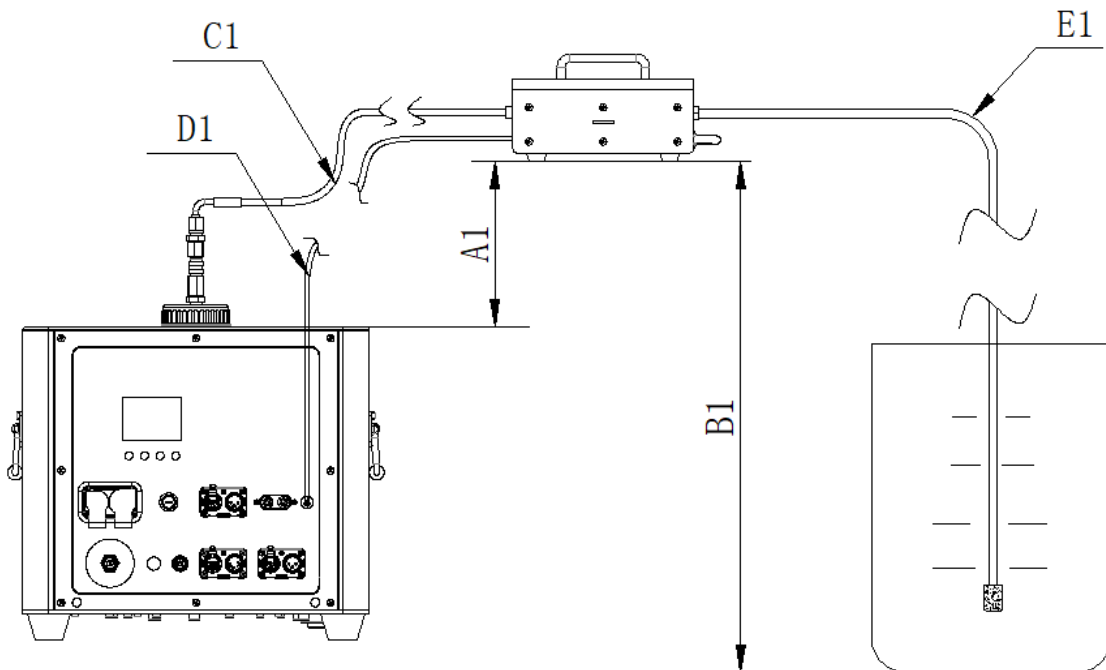

Explanation:

A1 is vertical distance between FLAMER and uPumper mini, $A1 \geq 0.3\text{m}$

B1 is vertical distance between uPumper mini and external fuel drum, $B1 \leq 2\text{m}$

C1 is the fuel output hose between Flamer and uPumper mini, $C1 \leq 1\text{m}$

D1 is power cable between FLAMER and uPumper mini, $D1 \leq 1\text{m}$, cable diameter requirement: 18AWG (0.75 square)

E1 is the fuel input hose between external fuel drum and uPumper mini, $E1 \leq 3\text{m}$

NOTICE:

$A1 \geq 0.3\text{m}$ is to make sure that fuel inside fuel output hose will drain to flamer fuel tank automatically after pumping, avoid fuel remains in fuel output hose spray to ground when disassemble the uPumper mini.

Application 2: Installed near external fuel drum

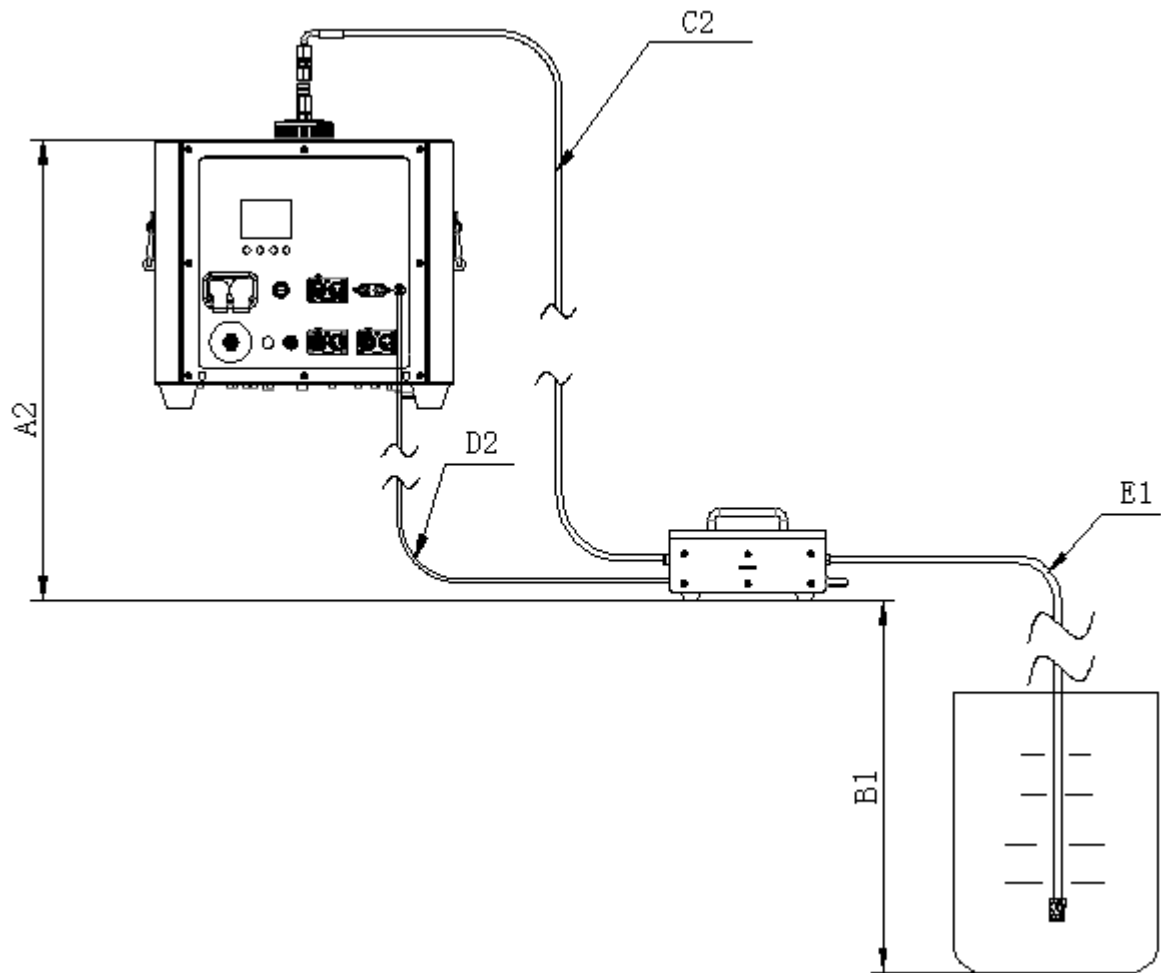

Explanation:

A2 is vertical distance between FLAMER and uPumper mini, $A2 \leq 10\text{m}$

B1 is vertical distance between uPumper mini and external fuel drum, $B1 \leq 2\text{m}$

C2 is the fuel output hose between Flamer and uPumper mini, $C2 \leq 15\text{m}$

D2 is power cable between FLAMER and uPumper mini, $D2 \leq 15\text{m}$, cable diameter requirement: 15AWG (1.5 square)

E1 is the fuel input hose between external fuel drum and uPumper mini, $E1 \leq 3\text{m}$

▲ Quick Operation Guide

1. Install both flamer and this uPumper mini on a horizontal firm surface or truss. For truss installation please do make sure install device with extra safety rope.
2. Connect the fuel input hose as show below.



3. Connect the fuel output hose and DC power cable as show below.



4. Replace the the fuel tank lid of flamer with below quick coupler tank lid.



5. Connect the other end of fuel output hose to quick coupler of tank lid.



6. Connect the other end of DC power cable to DC12V port on flamer as show below.



7. Put the other end of fuel input hose to external fuel drum. And please keep an eye on the fuel volume in the external fuel drum, refill it when it is necessary.

8. Parameters setting on flamer.

Power on flamer, enter “ADVANCED” menu, set “Fuel Input” to “ON”, set “PV ON Fuel Level” (default value is 20%) and “PV OFF Fuel Level” (default value is 90%) according to your requirement or local regulations.



9. Automatic fueling for flammers.

When fuel level in flamer fuel tank reached the setting “PV ON Fuel Level”, uPumper mini will activate automatically and refueling for the flamer, as refueling goes on when fuel level in flamer fuel tank reached the setting “PV OFF Fuel Level”, uPumper mini will stop working automatically.

10. Power off flammers, disconnect power cable for uPumper mini, disconnect the fuel hoses, pay special attention to the remaining fuel that may exist inside the fuel input and output hose to avoid spray to the ground or any other objects.

▲ Maintenance

1. To maintain the machine in good performance and running status, it is recommended to running the device at least once per month.

▲ Optional Parts for uPumper mini

Part. No.	Description
RMCAB117	DC Power cable, male to male, DC5.5*2.1mm, 0.75 square, 1m
SFCAB552	DC Power cable, male to male, DC5.5*2.1mm, 1.5 square, 15m
RMBOL087	High pressure fuel output hose with spring sheath, inner ϕ 3mm, 1m
RMBOL088	High pressure fuel output hose with spring sheath, inner ϕ 6mm, 15m
SFBOL0001	Fuel in PU hose, outer diameter ϕ 10mm, inner diameter ϕ 6.5mm, 3m
RMBOT036	Safety ring, M8*15
RMMET622	Safety rope, ϕ 5mm, length 300mm

▲ Warranty Instructions

- \ Sincere thanks for your choosing our products, you will receive quality service from us
- \ The product warranty period is one year. If there are any quality problems within 7 days after shipping out from our factory, we can exchange a brand new same model machine for you
- \ We will offer free of charge maintenance service for machines which with hardware malfunction (except for the instrument damage caused by human factors) in warranty period. Please don't repair machine without factory permission

Below situations NOT included in warranty service:

- \ Damage caused by use unqualified fuels;
- \ Damage caused by improper transportation, usage, management, and maintenance, or damage caused by human factors;
- \ Disassemble, modify or repair products without permission;
- \ Damage caused by external reasons (lightning strike, power supply etc.)
- \ Damage caused by improper installation or use;

For product damage not included in warranty range, we can provide paid service.

Invoice is necessary when applying for maintenance service from SHOWVEN

SHOWVEN[®]



Showven Technologies Co., Ltd.

Tel: +86-731-83833068

Web: www.showven.cn E-mail: info@showven.cn

Add: Liuyang Economic Development Zone, Changsha, 410300, Hunan Province,
P.R.China